

IMPORTANT

150807-1

IR Systeme Technik™ INSTALLATION GUIDE

PLEASE REFER TO THIS INSTRUCTION SHEET PRIOR TO INSTALLATION

The **IR Systeme Technik™** is designed to emit remote control signals effectively at the source devices connected to your **DigiSender®** product. This could be your Satellite or Cable receiver, VCR, DVD etc. **When installed correctly, this device will enable you to control your equipment from your bedroom or other remote location.**

Because everyone has their equipment set up differently, the Magic Eye comes included with a number of accessories. These enable the **IR Systeme Technik™** to be installed in many different ways. Please choose the most appropriate installation for your equipment setup.

IMPORTANT: THE MAGIC EYE CABLE MUST BE CONNECTED TO THE 'IR' SOCKET ON YOUR DIGISENDER® TRANSMITTER.

Please refer to your **DigiSender®** manual for further information.

IR Systeme Technik™ Magic Eye System & Accessories

Accessory #2
Round base



Accessory #1
Extension base

Magic Eye
Infra red emitter



Using the accessories



Vertical
Mounting #2

Vertical
Mounting #1

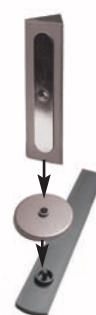

EXAMPLE #1

Stacked equipment under TV stand

The Magic Eye can be affixed to the underside of the TV stand using the supplied sticky foam pad.

Please ensure that the glass eye faces the equipment you wish to control, for example, your Satellite or Cable receiver.

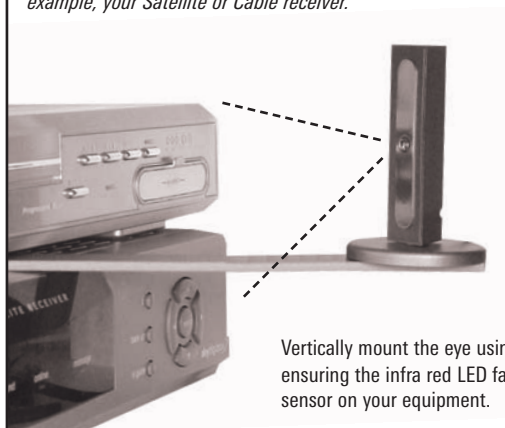

Vertically mount the eye using the accessory #1 ensuring the infra red LED faces the infra red sensor on your equipment.

EXAMPLE #2

Equipment stacked in a glass cabinet

The Magic Eye can be affixed directly to the inside of the glass door. When closed the eye will be facing the source equipment.

Please ensure that the glass eye faces the equipment you wish to control, for example, your Satellite or Cable receiver.

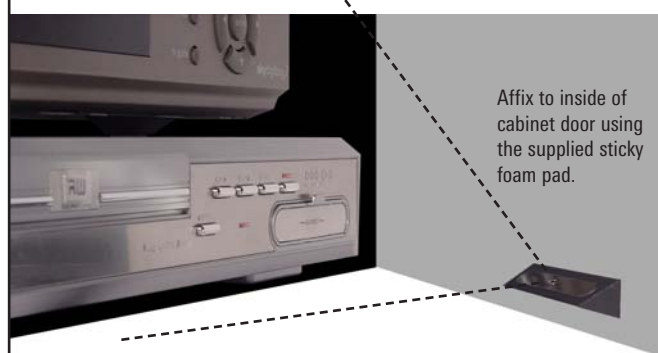

Affix to inside of cabinet door using the supplied sticky foam pad.

MORE EXAMPLES OVERLEAF...

EXAMPLE #3

Single item on a shelf

Use accessory #1 to place the Magic Eye at a short distance from the front of the Satellite or Cable receiver you intend controlling. Mount the Magic Eye in a vertical configuration.

Please ensure that the glass eye faces the equipment you wish to control, for example, your Satellite or Cable receiver.

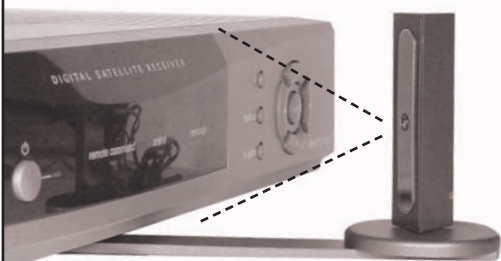

Vertically mount the eye using accessory #1 ensuring the infra red LED faces the infra red sensor on your equipment.

EXAMPLE #4

Multiple items on a shelf

Use accessory #1 with the Magic Eye in a horizontal position so IR signals are spread across both devices you intend controlling.

Please ensure that the glass eye faces the equipment you wish to control, for example, your Satellite or Cable receiver.

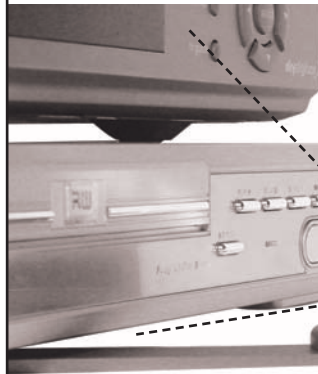

Horizontally mount the eye using the supplied sticky foam pad and accessory #1 to further the distance between eye and equipment.

EXAMPLE #5

Single item in cabinet or on a shelf (1)

The Magic Eye can be affixed to the base of the TV stand or cabinet using the supplied sticky foam pad. Place the eye in a horizontal position to ensure maximum spread of the IR signals.

Please ensure that the glass eye faces the equipment you wish to control, for example, your Satellite or Cable receiver.

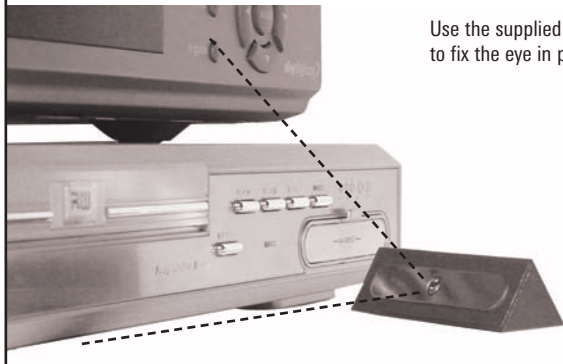

Use the supplied foam pad to fix the eye in position.

EXAMPLE #6

Single item in cabinet or on a shelf (2)

Accessory #2 can be used to mount the Magic Eye in a vertical position when used to control a single device.

Please ensure that the glass eye faces the equipment you wish to control, for example, your Satellite or Cable receiver.

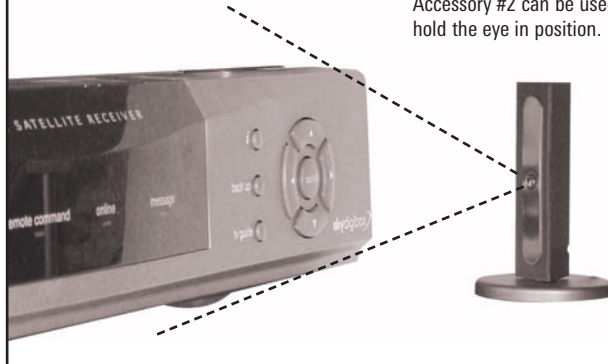

Accessory #2 can be used to hold the eye in position.

©2006 AEI Security & Communications Ltd. All rights reserved.

TECHNICAL SUPPORT

Telephone **0845 1667940**
or Email **advice@digisender.net**

We are open Monday to Friday, 9AM-1PM & 1.30 PM-5PM
Calls charged at local rate. Mobile rates may differ.