

Part No. LC-750S

# Remote Automation™ EcoSwitch™



## Introduction

EcoSwitch will convert your existing manually operated light switch to automatic movement activation.

You simply remove your old light switch and put the EcoSwitch in its place without the need to install any new wiring.

**IMPORTANT:**  
ALWAYS ISOLATE MAINS  
POWER SUPPLY PRIOR TO  
INSTALLATION.

IF IN DOUBT, ALWAYS SEEK  
PROFESSIONAL ADVICE.

## INSTALLATION (1-WAY LIGHTING CIRCUIT)

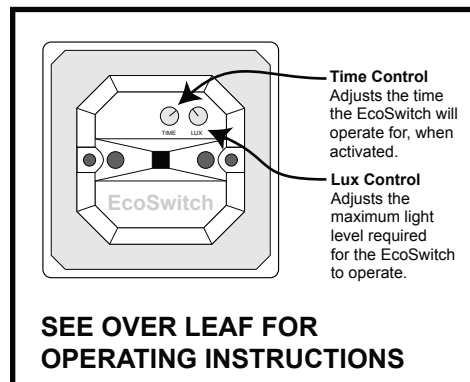
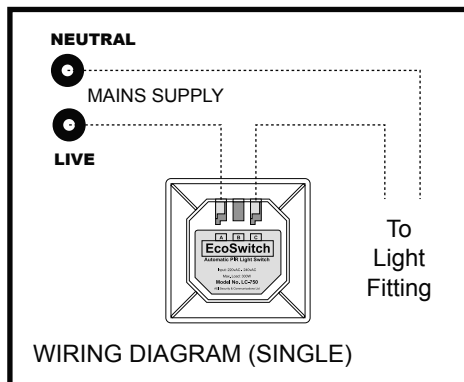

The EcoSwitch will replace any standard light switch with very little effort.

Remove the original light switch and connect the two existing wires to terminals **A** and **C** on the EcoSwitch. It does not matter which colour wire you connect to A or C

EcoSwitch keeps itself powered at all times by effectively stealing a miniscule amount of energy from the lighting circuit.

## INSTALLATION (2-WAY LIGHTING CIRCUIT)

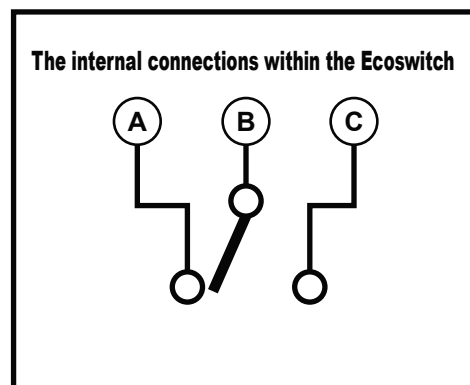
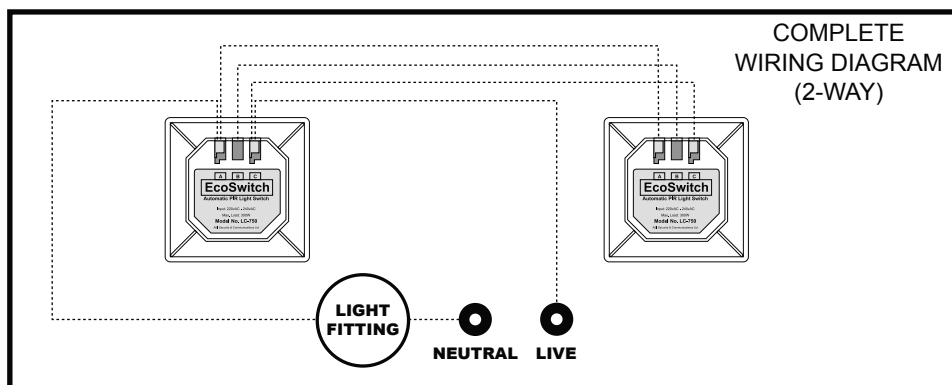

A pair of EcoSwitch modules can be used to replace any standard two-way light switches with no wiring modifications. EcoSwitch automatically detects when its terminal B is connected to another EcoSwitch terminal B and reconfigures its switch terminals electrocically

For two way light circuits connect to terminals **A**, **B**, and **C** on the EcoSwitch module. Please refer to diagram above with A to A, B to B & C to C with terminal B acting as the central pole switch

EcoSwitch works with any type of load: resistive or inductive. Resistive loads include standard (incandescent) lighting, while inductive loads include flourescent, low voltage and low energy lighting.

**DO NOT EXCEED THE MAXIMUM  
CURRENT RATING UNDER ANY  
CIRCUMSTANCES**

# SETTING UP YOUR ECOSWITCH

## 1) EcoSwitch Detection Area

The EcoSwitch detects movement as show in the diagrams opposite.

You can mount the EcoSwitch on your wall at about 1-1.5m height

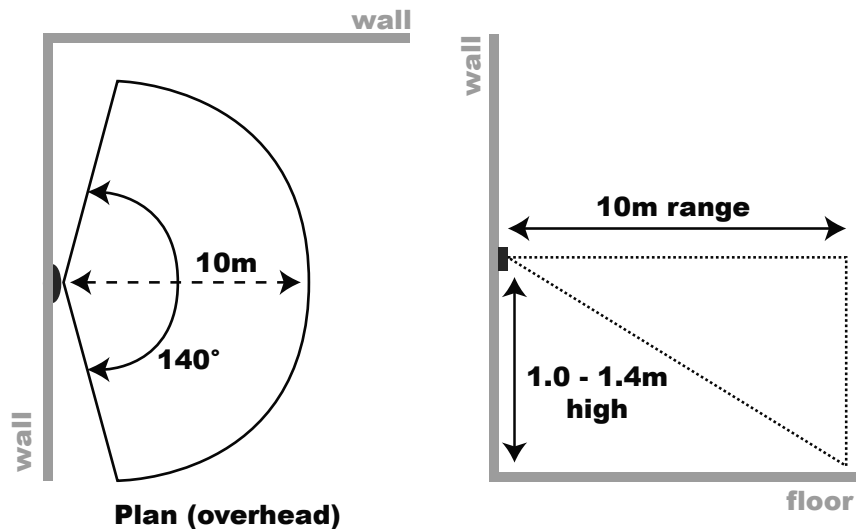

## 2) Adjust Illumination Level (LUX)

You can set the EcoSwitch only to switch on your lighting when the ambient light level goes below an adjustable threshold. This stops unnecessary power use during daylight hours.

## 3) Adjust time delay setting (TIME)

You can adjust the period of time the EcoSwitch stays on for when activated. It is variable between roughly 8 seconds and 6 minutes.

Adjust by altering the 'TIME' setting on the EcoSwitch.

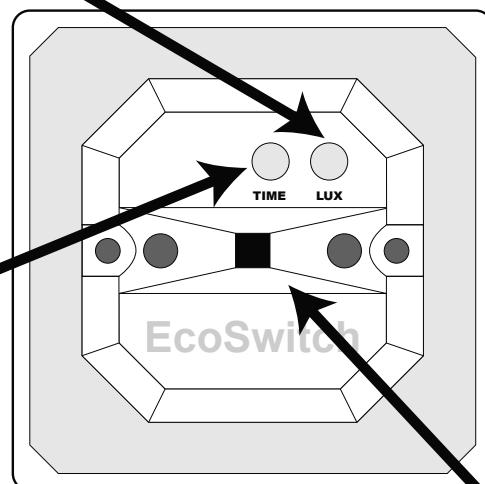

Infra-Red Sensor