

Part No. RADC02X2

Plug'n'go™

Wireless Door Chime

Installation Instructions



170505A

ALWAYS TEST YOUR DOOR CHIME PRIOR TO MOUNTING

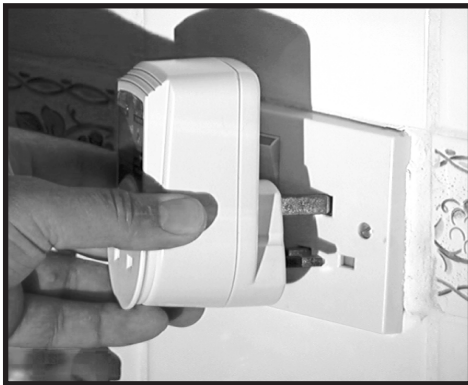

Step 1

Plug the chime unit into a convenient mains socket and switch the socket on. The orange light on the front of the chime unit should now glow.

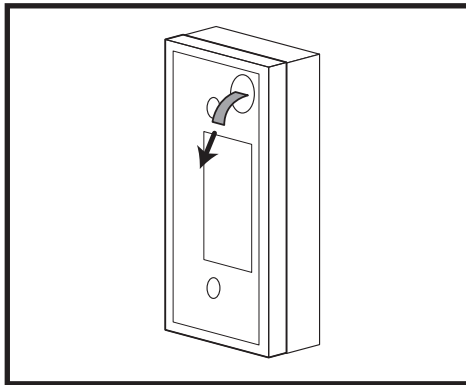

Step 2

Remove completely the battery saver tab from the rear face of the bellpush unit.

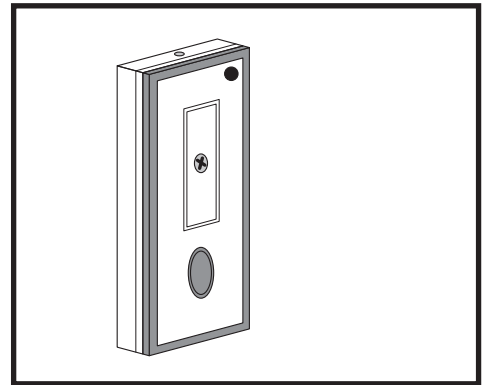

Step 3

Test the chime by pressing the button on the front of the bellpush unit. *Always test the chime and bellpush units in their desired location prior to mounting.*

NOW YOU HAVE TESTED THE OPERATION, YOU'RE READY TO INSTALL

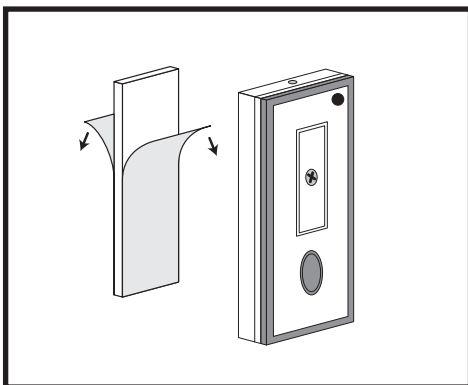

Step 4 (uPVC or Wood Frame)

Mount using the supplied double sided sticky pad. *Always test the door chime in the location you intend to install in.*

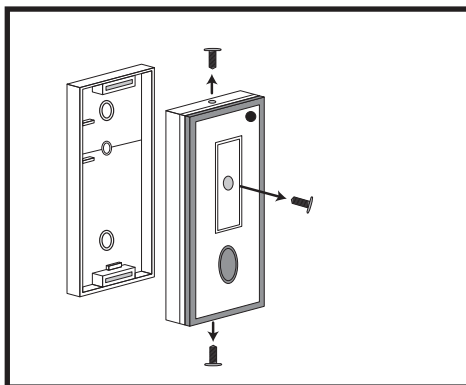

Step 4 (Wood Frame)

Mount using the supplied pair of screws. **(Not suitable for uPVC)** *Always test the door chime in the location you intend to install in.*

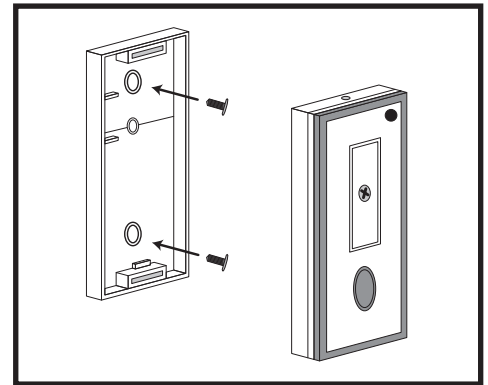

Attach the front of the bellpush unit and *We do not recommend screwing the backplate to a uPVC frame.*

CHANGING THE FRAME COLOUR

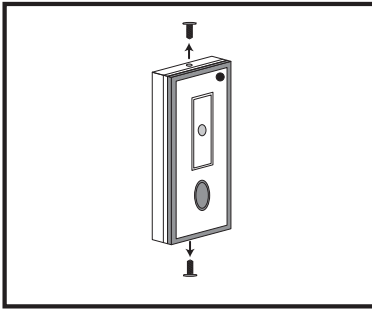

Step 1

Your door chime pack is supplied with multiple colour frames. To change, remove the 2 side screws.

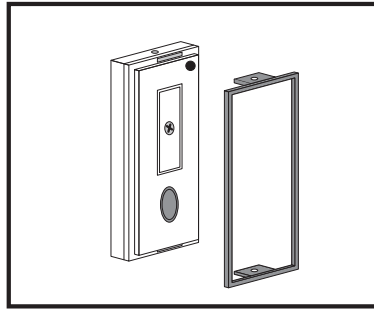

Step 2

- a) Gently slide the coloured frame forwards, holding at both ends.
- b) Insert your chosen colour frame and re-insert the 2 side screws.

CHANGING THE BATTERY

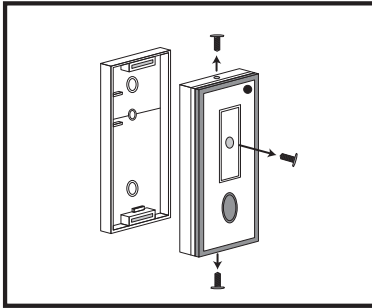

Step 1

Remove all 3 screws from the door chime case.

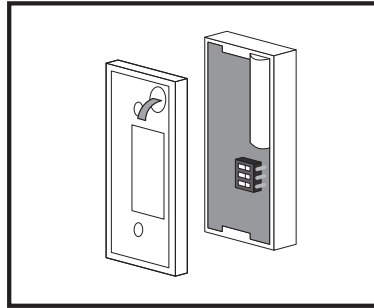

Step 2

Locate the existing battery and carefully replace with the new battery. Note the orientation of the existing battery.

Frequently Asked Questions (F.A.Q.)

Q: What is the typical range I can expect in an average location?
A: You can expect to obtain a range of between 8 to 25 metres.

Q: The range of my door chime seems rather low!
A: Range is dependent on many factors including the background radio frequency as well as the intended location of your bell push and chime unit. Always test the operation prior to installing and never fix the bell push unit until you are sure it works in the intended location. Try installing the chime unit in other power sockets.

Q: Can my push button be fitted to uPVC door frames?
A: Some plastic door frames incorporate metal extrusion within, which can interfere with the emitted radio frequencies from the bell push and reduce the range. We do not recommend using screws to fix the bell push to uPVC frame - as this may invalidate any warranty originally provided.

Q: Can the type of brick work, I intend mounting the bell push to, influence the range?
A: Yes. If the brick work incorporates an unusually high iron content or is made from flint or granite, it may also have a detrimental effect on range performance.

Q: Is it possible to regularly move the door chime from one location to another?
A: Yes. The chime unit is intended to be plugged into any mains socket within your home in range of the bell push.

Q: How long does the battery last in the bell push?
A: We provide a battery capable of maintaining operation of your door chime system for approximately 1 year or longer. Other long life batteries may provide operation up to 3 years.

Q: Is the bell push unit totally water proof?
A: The seal around the case, the push button and the LED is protected with the use of a rubber seal. You can provide additional protection by adding a small amount of silicone sealant at the point the mounting screws pass through the rear cover.

Q: Can the bell push be positioned open to the elements?
A: Yes. However, if you can provide additional protection within a porch or shielded from direct driving rain, then the life expectancy of your door chime will be dramatically increased.

MAINTENANCE FAQ

Q: Does my door chime need any maintenance?
A: Yes - when the battery requires replacement it will simply stop working. However the red light may still operate.

Q: How do I know if the battery is flat?
A: A good battery should read 12.0 to 13.5 Volts with a DC Multimeter

Q: What battery should I fit in the bell push unit?
A: The battery type is A23 12V. It is available from virtually all electrical retailers.

